

Montage-Anleitung
Spüle
mit 1 Tür ohne Blatt

Technische Änderungen vorbehalten
Kein Schadensersatz bei unsachgemäßer Montage

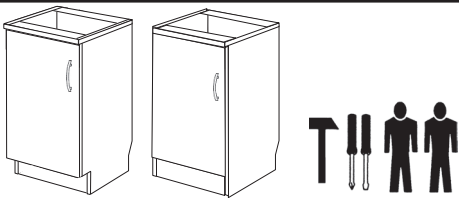

* Ausklinkung bei ausgeklinkten Seiten

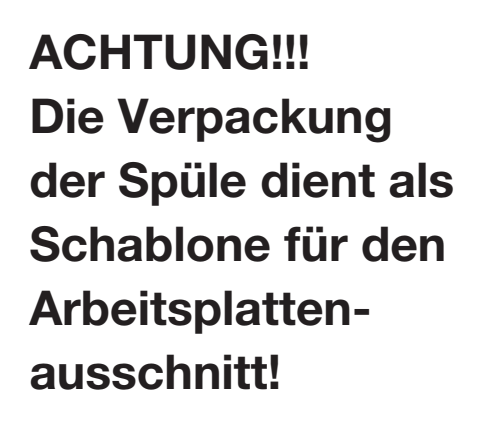
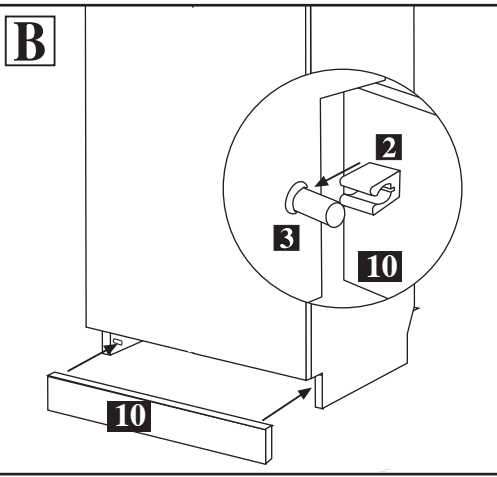
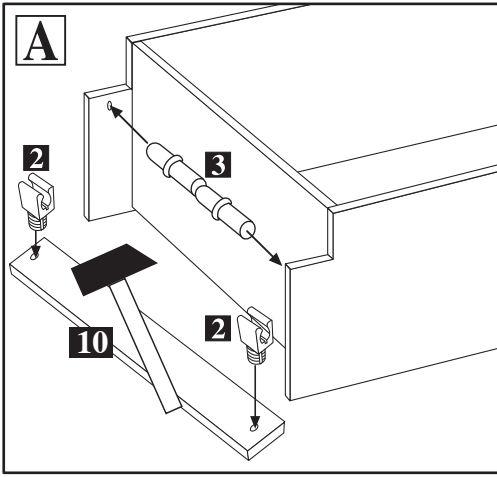
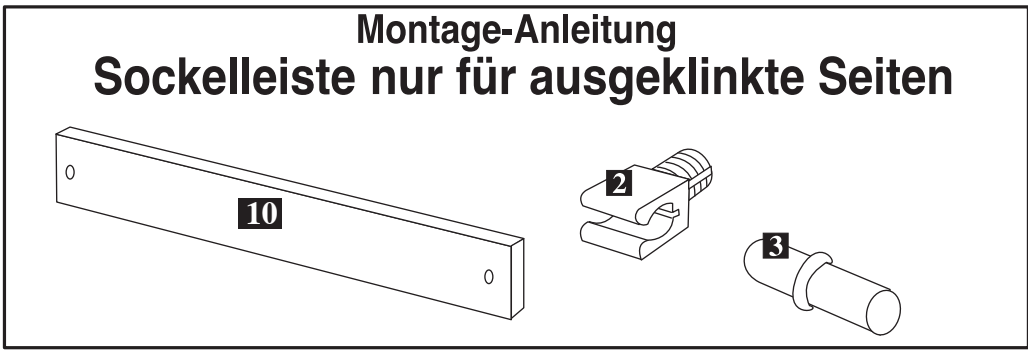
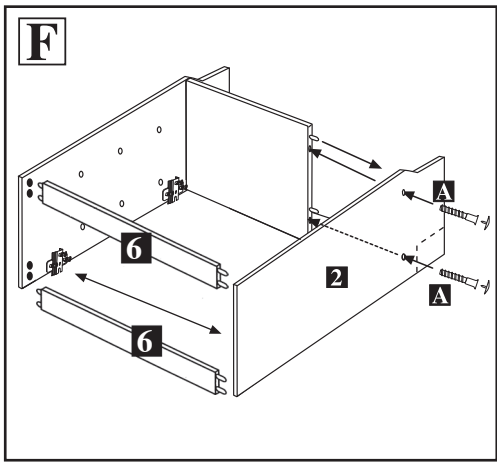
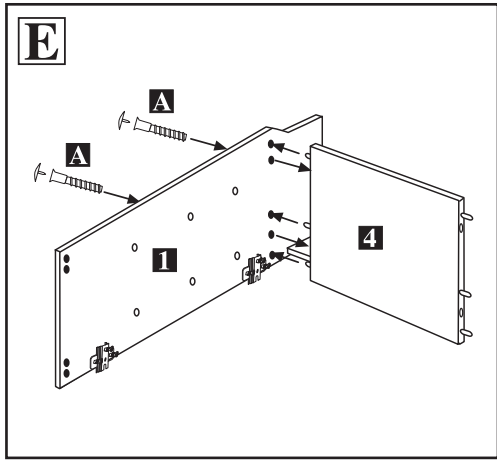
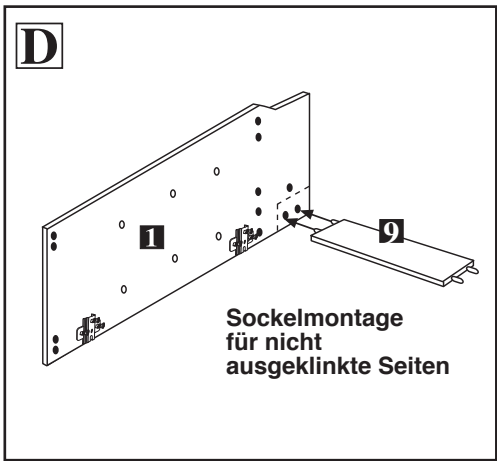
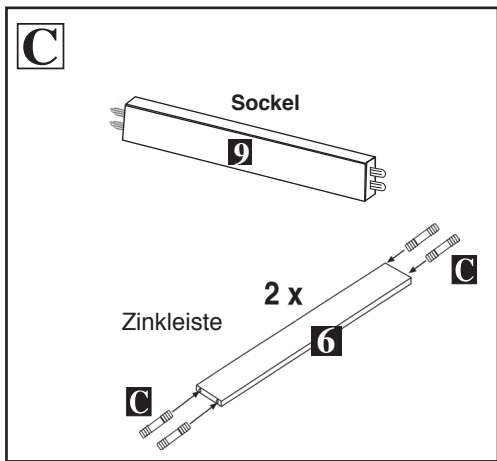
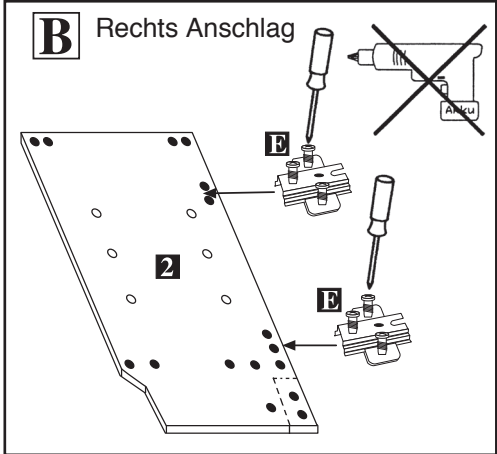
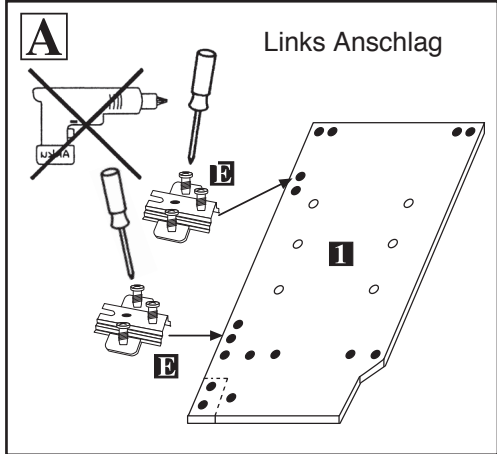
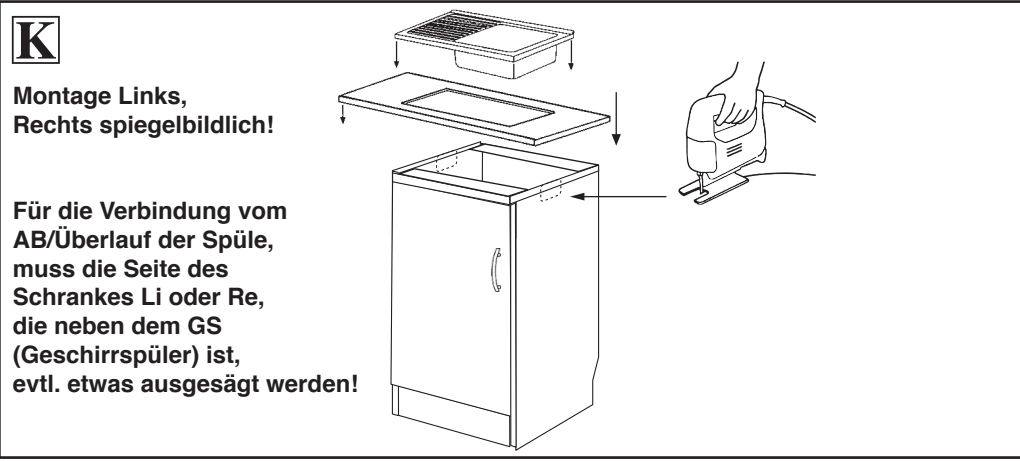
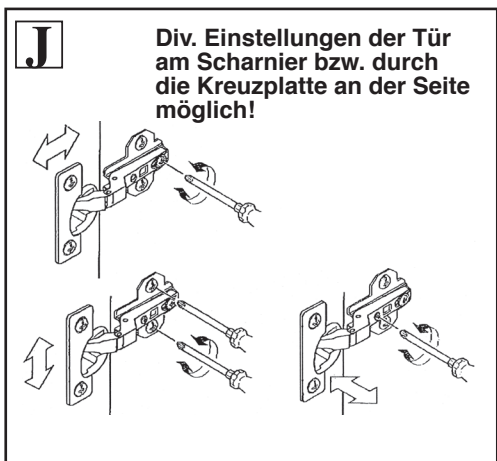
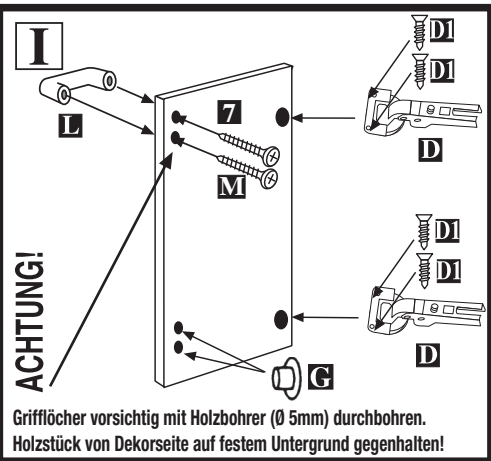
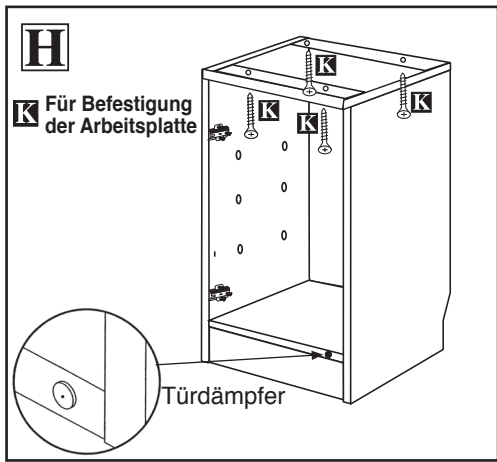
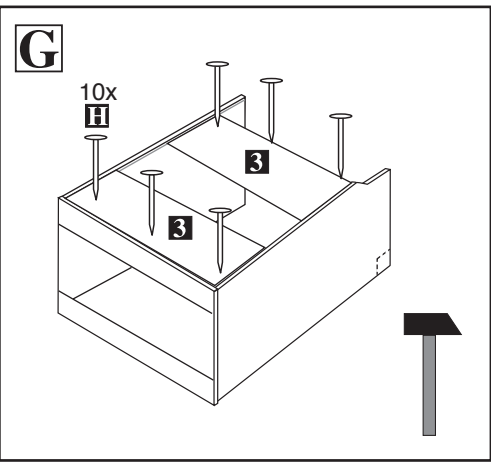
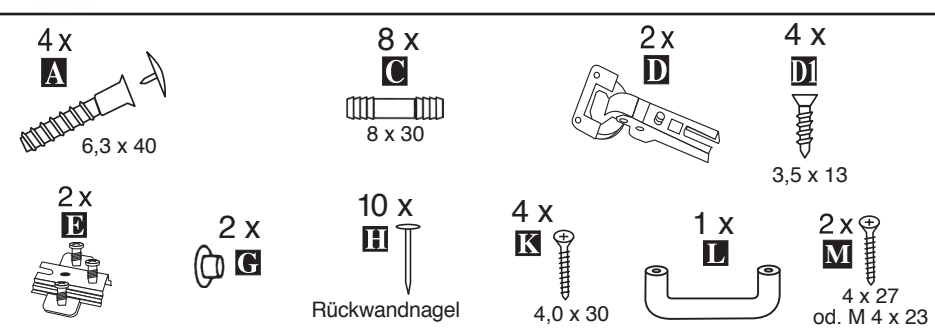
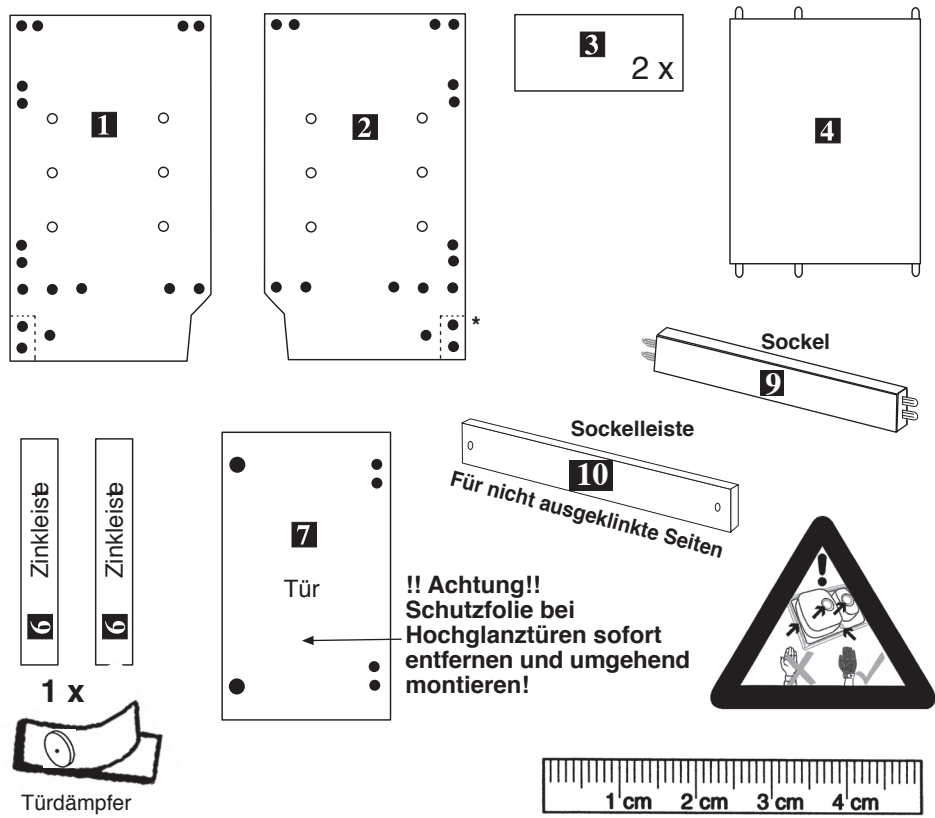

Montage-Anleitung

Sockelleiste für Geschirrspüler

ausgeklinkt

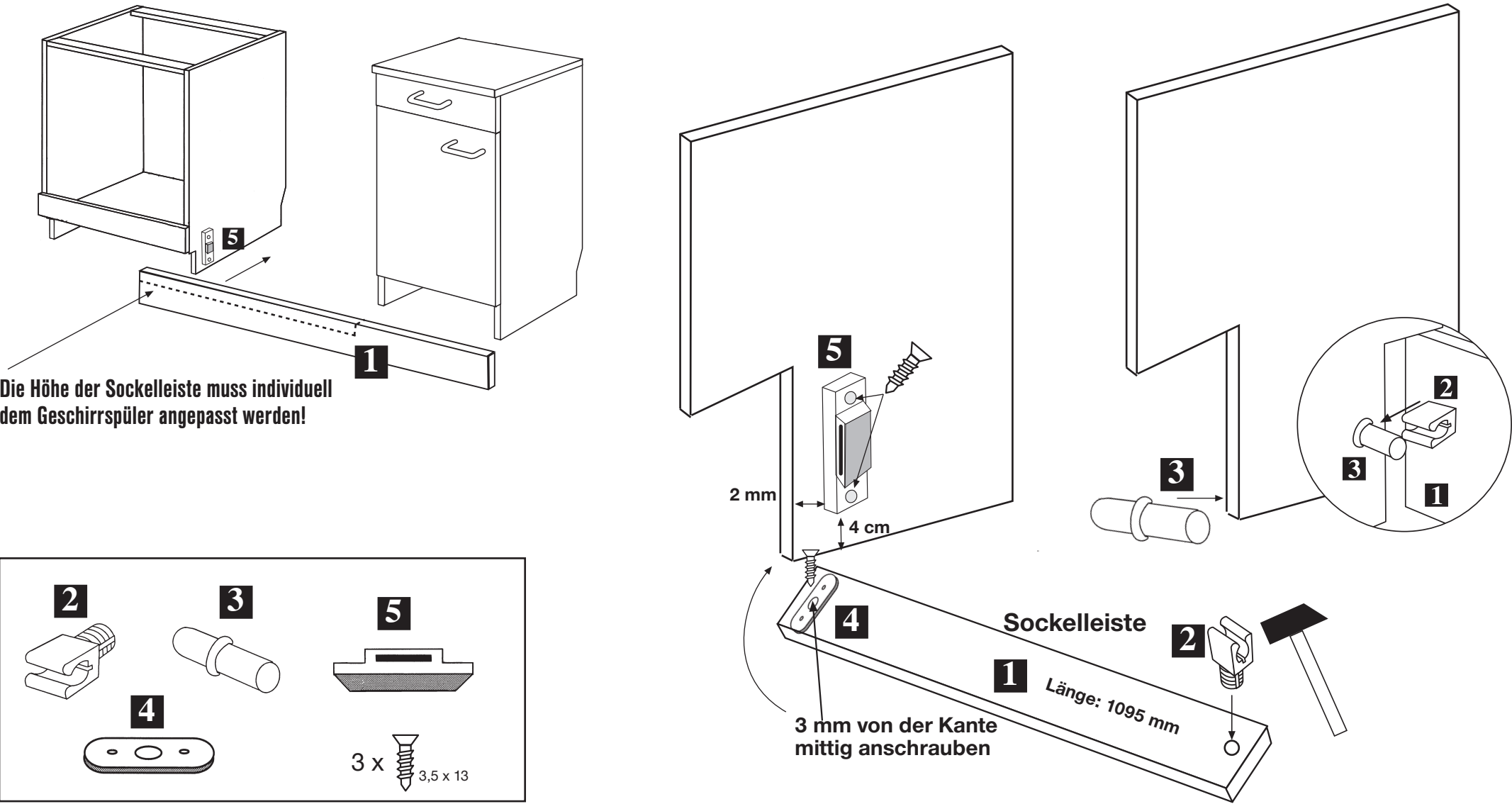

Montage-Anleitung

Sockelanpassung für Spüle 60 x 60 cm oder 50 x 60 cm

Sockelanpassungen = Länge kürzen
von Sockellänge 995 mm
für
Spüle 60 x 60 cm auf 600 mm kürzen
oder für
Spüle 50 x 60 cm auf 495 mm kürzen

